

PROJECT:

NOTES:

ORDERING INFORMATION:

EXAMPLE PUHE - 4F - L - 30 - 30 - 9 - 40 - MV - 2C - W - AM - P4L D
SERIES NOM. LENGTH SOURCE LUMENS UP LUMENS DOWN CRI KELVINS VOLTAGE CIRCUIT COLORS OPTIONS CONTROLS DRIVER

SHOP DRAWINGS

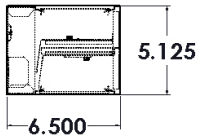

	A
PUHE-24	24"
PUHE-36	36"
PUHE-48	48"

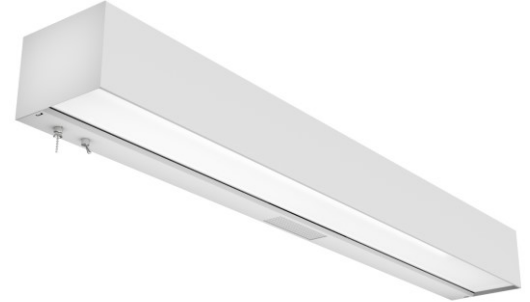

ORDERING INFORMATION

SERIES	
PUHE	

VOLTAGE	
MV	120-277V
347	347V

NOMINAL LENGTH	
2F	24"
3F	36"
4F	48"

CIRCUITS	
1C	1 Circuit
2C	2 Circuits

LUMENS UP*	
10	1,000
30	3,000
50	5,000

COLOR	
W	White
S	Silver
B	Black

LUMENS DOWN*	
10	1,000
30	3,000
50	5,000

OPTIONS	
AM	Anti-Microbial Paint
NLA	Indirect Amber LED night light (500 lumens)*
NLR	Indirect Red LED night light (500 lumens)*
NL	Indirect White LED night light (500 lumens)*

**Specify how night light will be controlled*

CRI	
BLANK	80 CRI
9	90 CRI

CONTROLS	
LV	Low Voltage Relay (Patient Controlled)**
P4L	4 Way Pull Chain (Left)*
P4R	4 Way Pull Chain (Right)*
P2L	2 Way Pull Chain (Left)*
P2R	2 Way Pull Chain (Right)*

**Pull chain options only available in 120V*
***Remote control not supplied by PA-CO*

KELVIN	
30	3000K
35	3500K
40	4000K
50	5000K
TW	Tunable White

DRIVERS	
ND	Non-dimming applications
D	0-10V dimming
DA	DALI driver

FEATURES

- > Premium grade wall-mounted luminaire designed as a bed light for hospitals, nursing homes and other patient care facilities
- > Provides controlled direct and indirect lighting
- > Solid construction with 18 gauge C.R.S faceplate and ends, 22 gauge C.R.S. housing with spot welded construction for enhanced structural strength
- > White opal lens
- > Optional night light can be direct (downlight) or indirect (uplight)
- > Optional 2-way pull switch or toggle switch for night light
- > Optional 4-way pull switch (off / uplight only / downlight only / fully on) or 2-way pull switch (on / off) for main luminaire control
- > Minimum 80 CRI; color range 3000K - 5000K available
- > Multiple dimming protocols available

APPLICATIONS

- > Hospitals
- > Nursing homes
- > Chronic care facilities

LED

FIXTURE PERFORMANCE DATA

SPECIFICATIONS

Housing / Faceplate / Ends –

Precision die and brake formed 18 gauge C.R.S faceplate and ends, 22 gauge C.R.S. housing with spot welded construction for enhanced structural strength

Diffuser – White opal lens

Finish – Baked white enamel powder finish applied post production on all surfaces for smooth edges and safe handling

Electrical – High quality mid-power LED boards. L70 >72,000 hours reported / 129,200 hours calculated. L85 >50,000 hours.

Mounting – Wall mounted

Listings –

■ cUL certified as luminaire suitable for dry or damp locations.

Warranty – 5-year limited warranty

LED PACKAGE	DELIVERED LUMENS	WATTAGE	EFFICACY (lm/W)
30 up / 30 down	6,436	45	143
50 up / 50 down	10,700	74	144

*Results based on 4000K, 80 CRI

MULTIPLIER TABLE	
COLOR TEMPERATURE	
CCT/CRI	CONVERSION FACTOR
3000K / 80 CRI	0.95
3500K / 80 CRI	0.97
4000K / 80 CRI	1
5000K / 80 CRI	1.03

FIXTURE DETAILS

