

PROJECT:

NOTES:

ORDERING INFORMATION:

EXAMPLE

PUCSA - 4F - 40 - 9 - 40 - MV - EM - BK - D1

SERIES NOM. LENGTH LUMENS CRI KELVINS VOLTAGE OPTIONS FINISH DRIVER

SHOP DRAWINGS

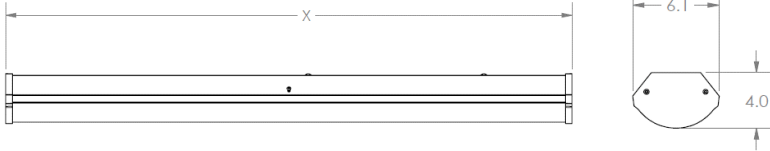

NOMINAL LENGTHS	X(inches)
2F	23.68"
4F	44.80"
6F	67.49"
8F	90.68"



ORDERING INFORMATION

SERIES
PUCSA

KELVIN
30 3000K
35 3500K
40 4000K
50 5000K
TW Tunable White

NOMINAL LENGTH
2F 24"
4F 45"
6F 68"
8F 91"

VOLTAGE
MV 120-277V
347 347V

LUMENS

OPTIONS

AC# Suspension Aircraft Cable #ft
BC# Black Cab Tire Wire #ft
WC# White Cab Tire Wire #ft
SM Stem Mount*
EM Emergency Power Pack
OS Internal occupancy and daylight harvesting sensor
H5 Opal overlay for better diffusion**
AB Amber LED***

*Stems not supplied by Pa-Co
**The overlay diffuser will reduce efficacy by 15-20%
***Lumen package to be determine

FINISH

BLANK White
BK Texture Matte Black
AM Antimicrobial White
MW Texture Matte White

DRIVER

ND Non-dimming applications
D 0-10V dimming
D1 0-10V dimming to 1%
DA DALI driver

FEATURES

- > Architectural high-abuse surface or pendant-mounted wraparound LED luminaire with robust yet stylish construction
- > Cast aluminium end caps
- > UV-stabilized, high-impact extruded polycarbonate lens locked in place with tamper-resistant screws
- > Minimum 80 CRI; color range 3000K - 5000K available
- > Tunable White option available
- > Mounting accessories available for surface or suspended mounting
- > Multiple dimming protocols available
- > IK10 rated

APPLICATIONS

- > Rough service applications
- > Stairwells
- > Corridors
- > Locker rooms
- > Schools

Lumen Package*	Nominal Lumens
2F	
20	2,000
40	4,000
4F	
40	4,000
60	6,000
80	8,000
6F	
60	6,000
80	8,000
100	10,000
8F	
120	12,000
140	14,000
160	16,000

*Other lumen packages available.

CRI

BLANK 80 CRI
9 90 CRI

FIXTURE PERFORMANCE DATA

SPECIFICATIONS

Housing – Precision die-formed 16-gauge C.R.S. Die cast impact resistant aluminium end caps.

Shielding – UV-stabilized, high-impact extruded polycarbonate lens locked in place with aluminium casting end caps and tamper-resistant screws

Finish – Baked white enamel powder finish applied post production on all surfaces for smooth edges and safe handling

Electrical – High quality mid-power LED boards. L70 >72,000 hours reported / 129,200 calculated at maximum allowable output current. L85 >50,000 hours.

Mounting – Suspended or surface

Listings –
 ■ cUL certified as luminaire suitable for dry or damp locations.

Warranty – 5-year limited warranty

LED PACKAGE	DELIVERED LUMENS	WATTAGE	EFFICACY (lm/W)
2F			
40	3,804	42	91
4F			
40	3,915	43	91
60	6,031	64	94
80	7,833	86	91
6F			
60	6,117	61	100
80	8,093	85	95
100	9,896	106	93
8F			
120	12,059	130	93
140	14,196	154	92
160	16,154	142	114

*Results based on 4000K, 80 CRI

MULTIPLIER TABLE	
COLOR TEMPERATURE	
CCT/CRI	CONVERSION FACTOR
3000K / 80 CRI	0.95
3500K / 80 CRI	0.97
4000K / 80 CRI	1
5000K / 80 CRI	1.03

FIXTURE DETAILS

Surface mounting

Refer to installation instructions for mounting hole distances.

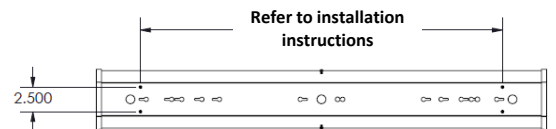
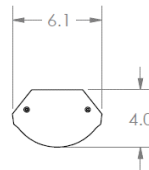

Pendant on Stem

Easy installation including set of canopies with stems to mount on ceiling. Refer to installation instructions for mounting hole distances.

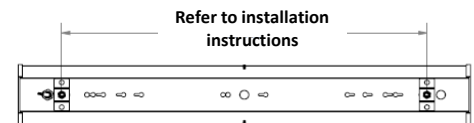
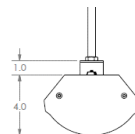

Pendant with Aircraft cables

Easy installation including set of canopies to mount on ceiling. Refer to installation instructions for mounting hole distances.

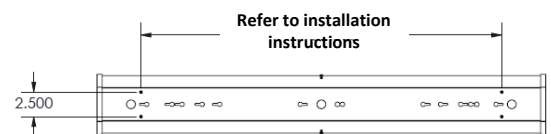
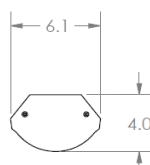

PHOTOMETRY

PUCSA-4F-40-40-MV Total Luminaire Output: 3,915 lumens; 43 Watts

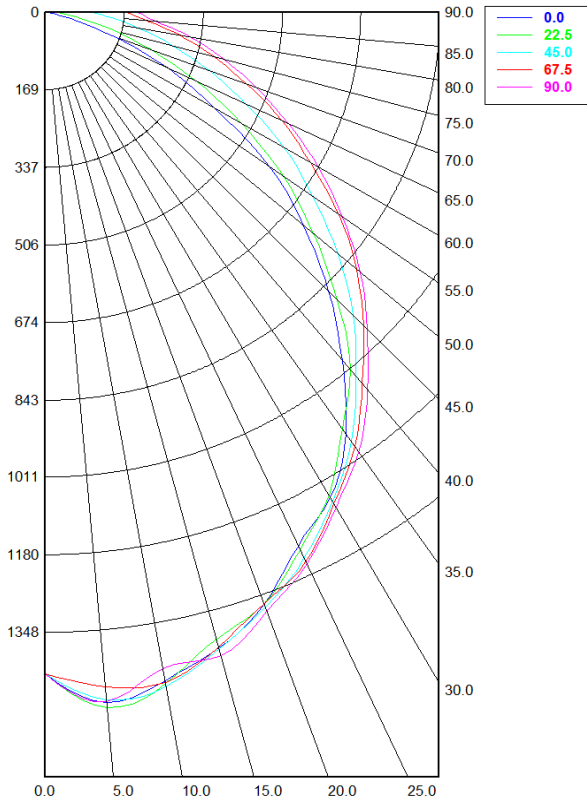

Candela Distribution

	0.00°	22.50°	45.00°	67.50°	90.00°
0.00°	1143.24	1143.24	1143.24	1143.24	1143.24
5.00°	1135.03	1130.27	1139.29	1136.72	1135.41
10.00°	1126.62	1122.73	1123.95	1125.33	1119.55
15.00°	1092.35	1091.08	1094.96	1099.77	1098.07
20.00°	1047.57	1054.15	1056.48	1066.68	1063.68
25.00°	1004.92	1005.34	1016.12	1021.67	1027.42
30.00°	932.93	946.20	958.65	969.45	978.25
35.00°	869.06	876.60	900.46	914.55	921.63
40.00°	790.53	804.11	827.93	854.41	862.44
45.00°	707.90	724.39	757.77	786.63	800.15
50.00°	618.17	640.57	682.38	721.17	738.93
55.00°	522.58	554.37	612.31	656.88	673.35
60.00°	427.49	469.15	539.68	593.71	614.62
65.00°	336.34	386.99	468.78	527.47	550.67
70.00°	246.54	309.79	404.14	466.64	488.33
75.00°	168.80	240.71	340.91	406.42	429.75
80.00°	104.79	178.85	281.88	349.40	372.74
85.00°	53.88	123.98	228.19	293.66	317.77
90.00°	15.46	80.70	178.57	244.27	266.68

Spacing Criterion

Two luminaires, plane 0°	1.21
Two luminaires, plane 90°	1.26
Four luminaires	1.37

Zonal Lumen Summary

Zone	Lumens	% Fixture
0° - 10°	114.56	2.93%
10° - 20°	308.06	7.87%
20° - 30°	465.49	11.89%
30° - 40°	559.05	14.28%
40° - 50°	581.72	14.86%
50° - 60°	540.73	13.81%
60° - 70°	452.55	11.56%
70° - 80°	340.84	8.70%
80° - 90°	228.47	5.83%
90° - 100°	137.62	3.51%
100° - 110°	78.60	2.01%
110° - 120°	43.63	1.11%
120° - 130°	24.93	0.64%
130° - 140°	15.79	0.40%
140° - 150°	10.86	0.28%
150° - 160°	7.12	0.18%
160° - 170°	4.24	0.11%
170° - 180°	1.58	0.04%
0° - 90°	3591.48	91.72%
90° - 180°	324.40	8.28%
0° - 180°	3915.87	100.00%

